

DeskProto[®]

3D CNC machining for non-machinists

New in Version 6.0

Editions

Starting with V6, DeskProto is available in three Editions:

The **Entry Edition** replaces the Lite version, and is the lowest cost license for simple 3-axis work. Bitmap machining and 2D machining are included

The **Expert Edition** includes all available options, however only for 3-axis machining.

The **Multi-Axis Edition** is the flagship edition and also supports four axis machining and five axis machining.

A complete list of differences can be found in the Edition comparison table on the DeskProto website.

All these editions share the same Setup (so only one download is available): the Unlocking code that you receive after purchasing decides which edition will be started. The dongle (hardware security key) that was present will no longer be used, which will save shipment cost.

Completely new features

- Completely **new wizards** : including more options, nevertheless easier to use - see the picture on the right. These wizards will automatically generate operations for Roughing and for a smoothing Contour. Also wizards for 2D milling and for Bitmap-to-Relief conversion are present.
- **Five axis machining** : DeskProto now supports five-axis indexed machining, so for machines with CNC controlled A and B rotation axes. This makes models possible that could not have been made on a three axis machine, see for instance the Austin Healey Gallery project (picture on the back side).
- **Multi-threaded toolpath calculations** : on multi-core PCs so far DeskProto could use only one core. Resulting in the CPU Usage not rising above 25% on a quad-core machine, which is annoying for long calculations. Now each operation will be assigned a core, which is much faster.
- **Ramping** now is possible, for the first movement of each operation. Ramping means that the cutter enters the material along a sloping line instead of by making a vertical drilling movement.
- The new **Welcome screen** offers a clear overview of all available options.



The three editions, in the new Trial screen

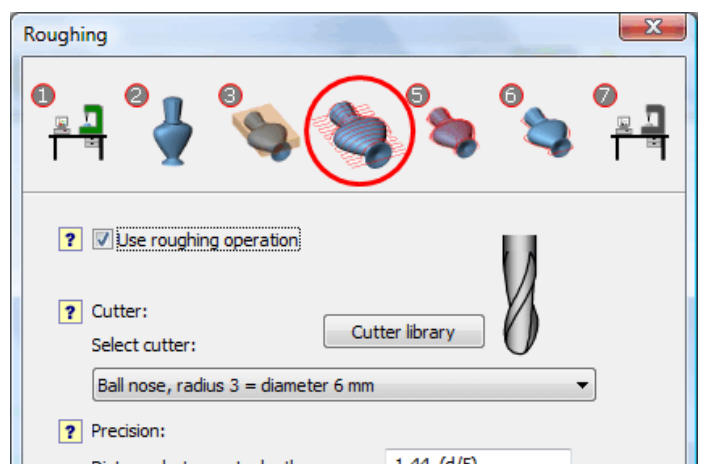

The new Wizard, with pages for roughing and finishing.

Improvements in the user-interface and internally:

- DeskProto now can be started **without administrator rights** . The previous version could not, which was a problem for many schools and large companies.
- DeskProto now runs OK in the **Aero interface** : translucency, 'glowing' buttons, flip 3D, etc.
- Faster loading of large (complex) DPJ files.
- The **OpenGL Graphics** in DeskProto V6 have been completely redone:
 - . **Graphics hardware acceleration** : the power of the processor on the graphics card is now exploited when changing the viewpoint.
 - . For large bitmap files now a simplified version is used to draw on the screen, which makes drawing much quicker (for calculating toolpaths the original data are used).
 - . Removing hidden lines now is done by the graphics card: gives much better results.
 - . New Preferences for the graphics: Use **AntiAliasing** and Optimize simulation rendering.

Other new features and improvements

- Also for a Freeform segment the **Border options** are available.
- Importing a DXF file with **3D polylines** in a 2D Operation (resulting in a 3D toolpath).
- The Load Geometry dialog can also open 2D and Bitmap files (will automatically add such operation).
- Option Help >> **Create problem report** bundles all files needed to mail a project.
- Mouse zooming more intuitive: the effect on the zoom is made relative to the current zoom factor.
- Extra option for **Skip Ambient** : 'Only skip hor. and vert. movements'.
- Extra postprocessor option "Leading zeros", for machines that need line numbers with a fixed length.
- The **Support blocks** have been completely redone: more than 4 blocks, various models, custom support blocks can be added, any size and orientation.
- New **optimization** for waterline toolpaths (less positioning within one layer), will save much time for very complicated geometries.
- Edit Freeform segment shows the points on the segment's contour line when editing this line.
- In 2D operations the 2D data also can be mirrored

Updates

DeskProto V 6.0 is a major update, meaning that for users of previous DeskProto versions this will be a paid update. Any client who has bought his/her license after **May 1st, 2011** will receive an update to Version 6 **free of charge** .

Update prices, commercial license:

You now have:	V3-5 Lite	1-4 Full or 4.2	V5 Full
Upgrade to:			
V6 Entry	58	-	-
V6 Expert	498	238	198
V6 Multi-Axis	898	598	398

Update prices, educational and hobby license:

You now have:	V3-5 Lite	V4.2	V1-5 Full
Upgrade to:			
V6 Multi-Axis	148	-	98

A special **20% introduction discount on Upgrades** is offered in December 2011 and January 2012 ! On the commercial upgrade V4.2 > V6 Multi-Axis even 33 %. As all V4.2 hobby licenses have been purchased after May 1st, all will receive a free upgrade. All prices are in Euro, and excl. VAT.



Five-axis machining a scale model using the DeskProto CAM software. Picture courtesy of Robert Zeinecker.

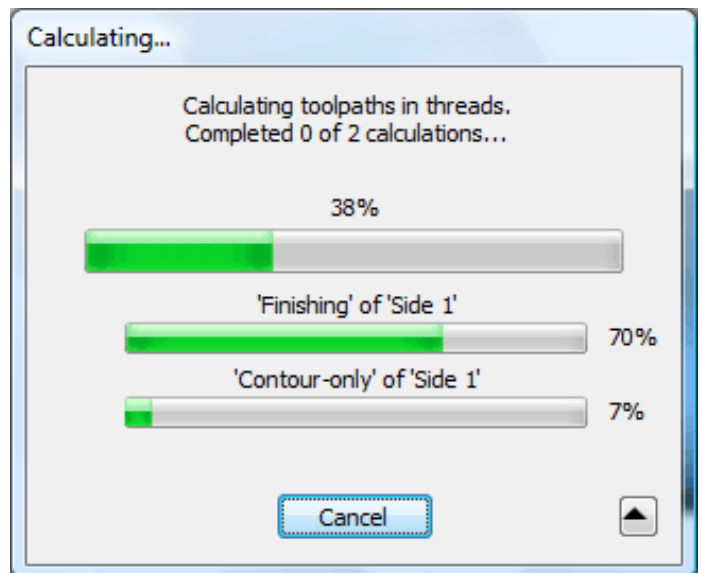

Multi-threading: on a dual-core machine two calculations can be done at the same time, on a quad-core four, etc.

New licenses

	Commercial	Educational	Hobby
V6 Entry	145	-	-
V6 Expert	595	-	-
V6 Multi-Axis	995	248	248

Compatibility

DeskProto V 6.0 runs OK using **Windows XP** (Service Pack 3 or newer needs to be installed), **Windows Vista**, **Windows 7**, or newer. Both the **32 bits** and the **64 bits** versions are supported: on a 64 bits Windows the Setup will automatically install a 64 bits build of DeskProto (all editions).

So Windows 2000 is no longer supported. Win95, Win98 or WinNT already had been dropped for DeskProto V 5.